

■ EXPLODED VIEW & PARTS LIST

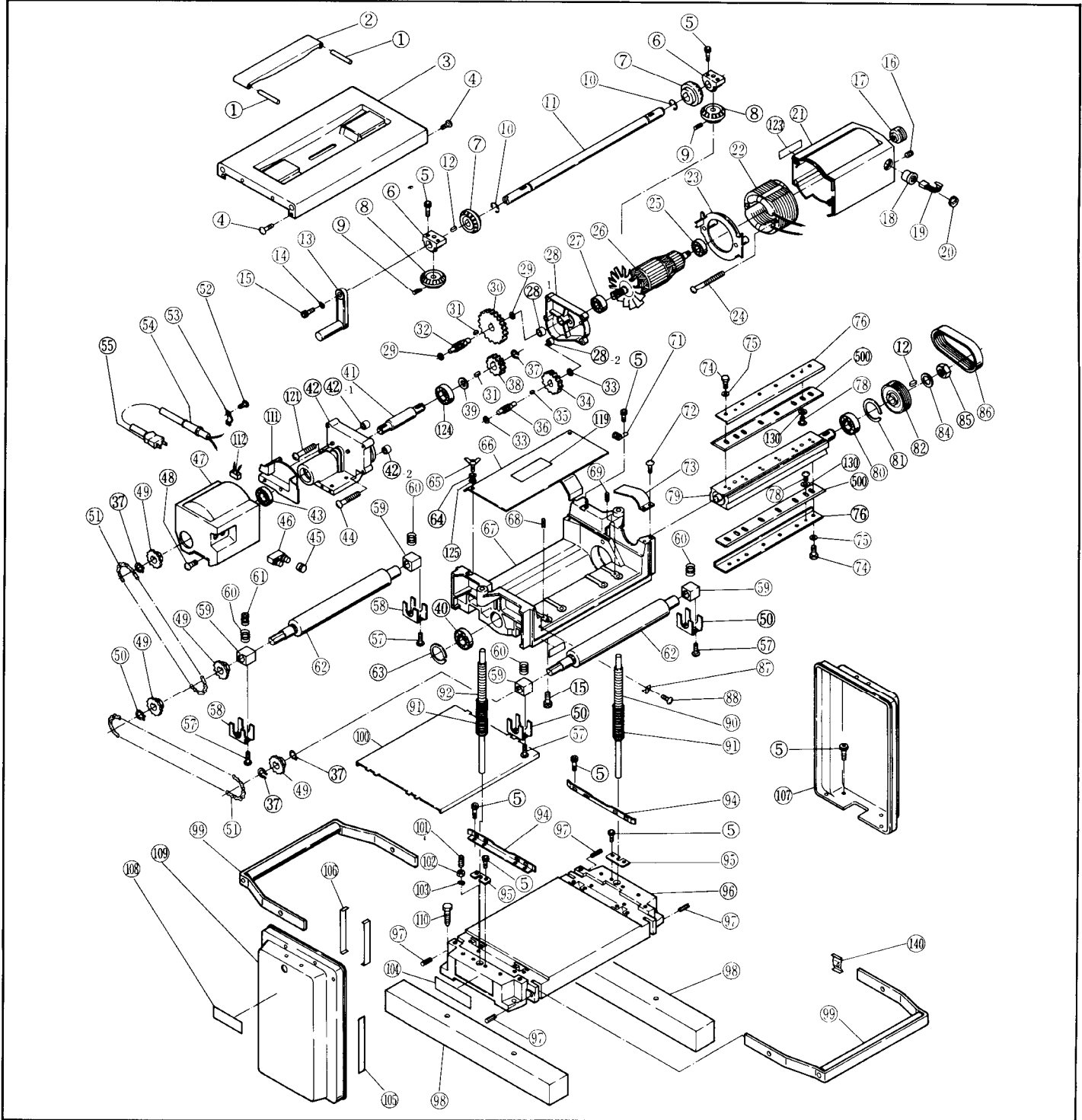

Ref.No.	Description	Ref.No.	Description	Ref.No.	Description
1	Parallel Pin	38	Final Gear (3)	78	Phillips Pan Screw M5×8
2	Aux. Handle	39	Thrust Washer 15.2×23×0.5	79	Cutter Block
3	Cover	40	Ball Bearing #6202LLB	80	Ball Bearing #6203LLB
4	Tapping Screw (S) M5×10	41	Gear Shaft	81	Retaining Ring R-40
5	Hex. Socket Head Bolt M6×12	42	Gear Case Ass'y.	82	Pulley (L)
6	Holder	42-1	Oilless Metal 8×11×10	84	Conical Spring Washer
7	Bevel Gear (A)	42-2	Oilless Metal 6×9×8	85	Hex. Nut
8	Bevel Gear (B)	43	Ball Bearing #6002ZZ	86	Poly V-Belt 135-J6
9	Spring Pin 4×25	44	Tapping Screw (B) M5×50	87	Scale Arrow
10	Retaining Ring E-12	45	Switch Guard	90	Screw (L)
11	Handle Shaft	46	Push Button Switch ABK-161	91	Compression Spring
12	Parallel Key 4×4×14	47	Switch Case	92	Screw (R)
13	Handle Ass'y.	48	Tapping Screw (S) M4×12	94	Guide Plate
14	Spring Washer M6	49	Chain Sprocket	95	Set Plate
15	Hex. Socket Head Bolt M6×20	50	Metal Cover	96	Base
16	Clamp Screw M5×8	51	Chain	97	Spring Pin 6×20
17	Pulley	52	Tapping Screw (B) M4×16	98	Stock
18	Brush Holder	53	Cord Clamp 11.1mm	99	Roller Ass'y.
19	Carbon Brush (1 pair)	54	Cord Holder 10mm	100	Slide Plate
20	Brush Cap	55	Cord Ass'y. AWG #14×3×2	101	Clamp Screw M6×20
21	Motor Housing	57	Tapping Screw (S) M5×12	102	Hex. Nut M6
22	Field Coil Ass'y.	58	Metal Cover	104	Name Plate
23	Fan Casing	59	Straight Metal	105	Scale
24	Tapping Screw (B) M5×70	60	Compression Spring	106	Spacer T=0.3
25	Ball Bearing #6201LLB	61	Compression Spring	107	Cover (R)
26	Armature Ass'y.	62	Feed Roller	108	Plate
27	Ball Bearing #6200LLB	63	Retaining Ring R-35	109	Cover (L)
28	Inner Cover Ass'y.	64	Washer	110	Wood Screw
28-1	Oilless Metal 8×11×10	65	Wing Bolt M5×12	111	Switch Cover
28-2	Oilless Metal 6×9×8	66	Dust Filter	113	Mark Plate
29	Thrust Washer 8.1×12×0.5	67	Roller Case	119	Indication Label
30	Final Gear (2)	68	Parallel Pin (A)	121	Tapping Screw (B) M5×60
31	Parallel Key 4×4×10	69	Parallel Pin (B)	123	Seal
32	Pinion Shaft (2)	71	Cord Stand	124	Ball Bearing #6202ZZ
33	Thrust Washer 6.2×11×0.5	72	Tapping Screw (S) M4×10	125	Toothed Lock Washer
34	Final Gear (1)	73	Belt Cover	130	Washer
35	Parallel Key 3×3×5.8	74	Hex. Head Bolt M6×17	140	Spring Plate
36	Pinion Shaft (1)	75	Washer	500	Planer Blade
37	Retaining Ring S-15	76	Blade Binder		