

R.375 OUTER
EDGES ONLY

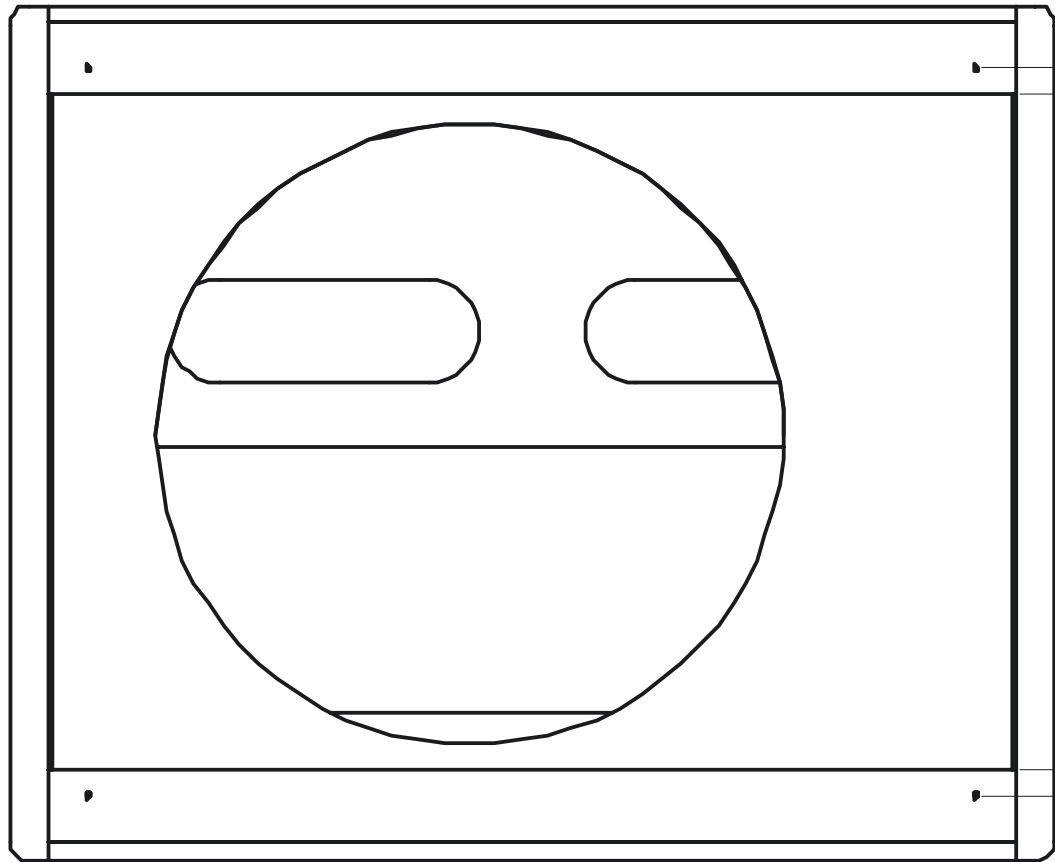
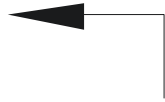

(.50)

(.50)

.250 MIN

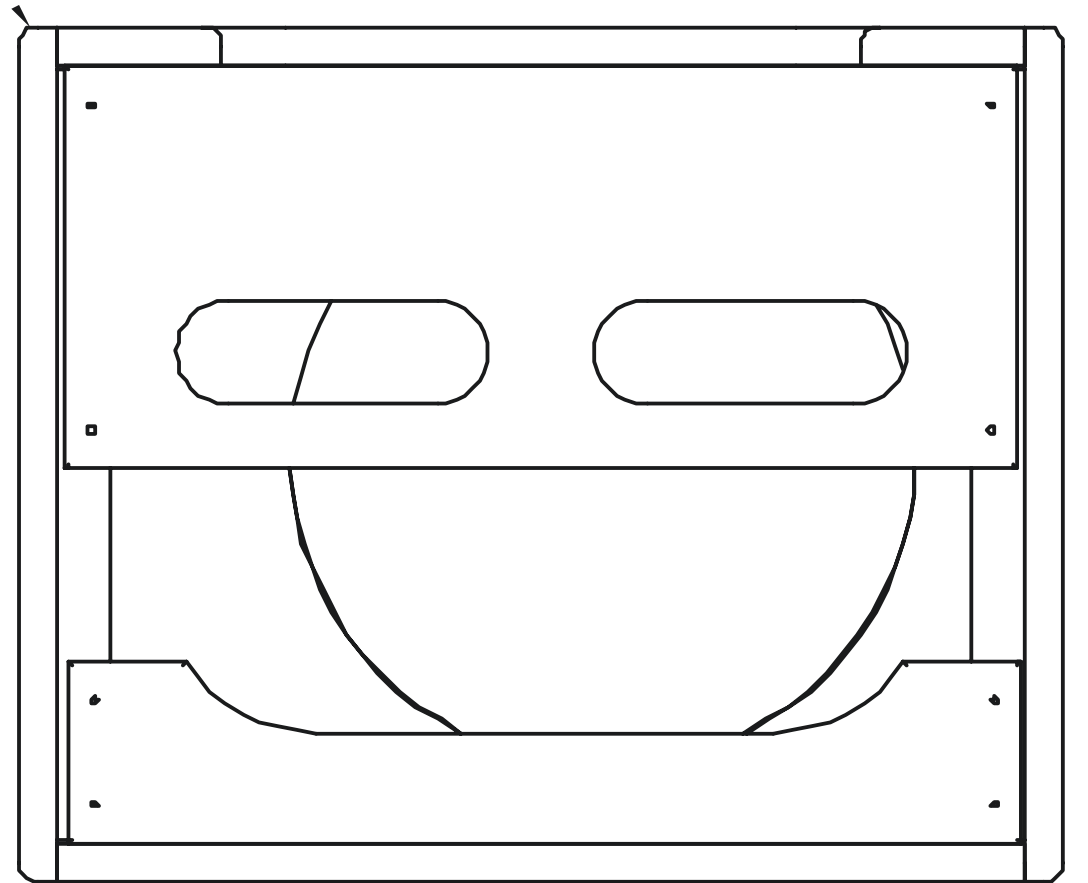
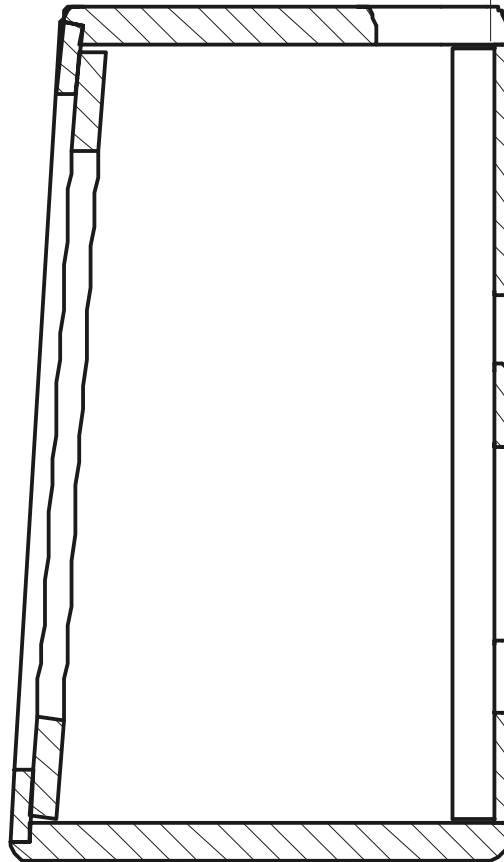

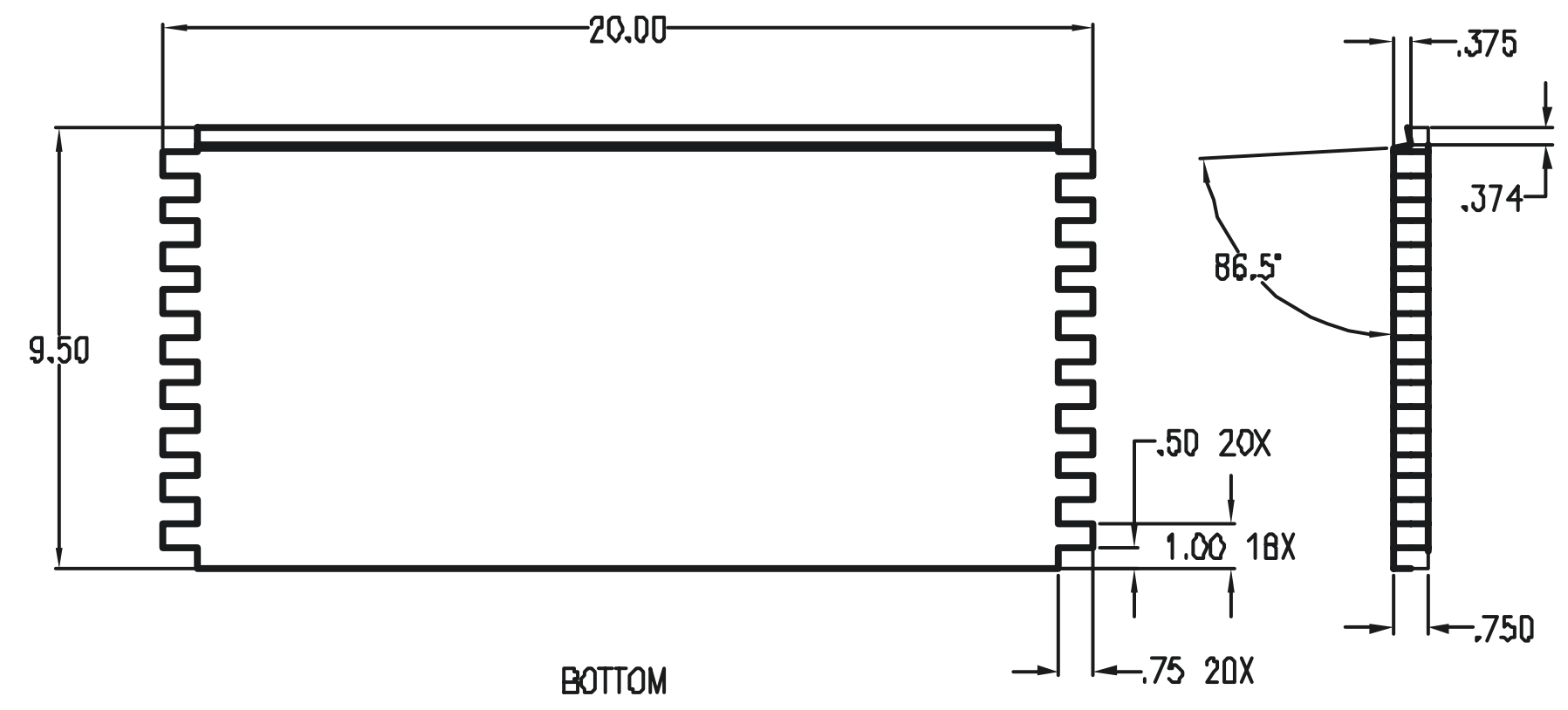
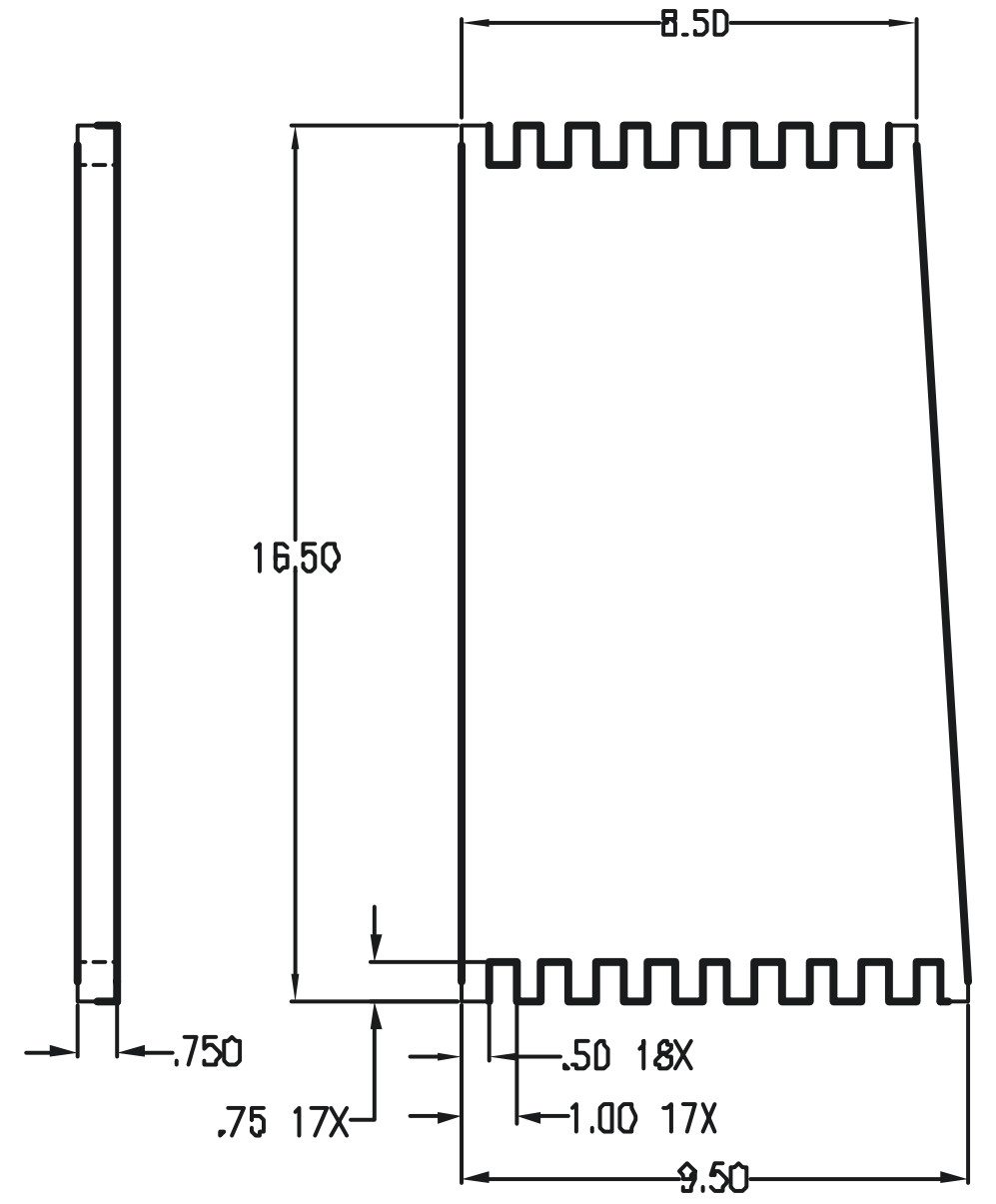
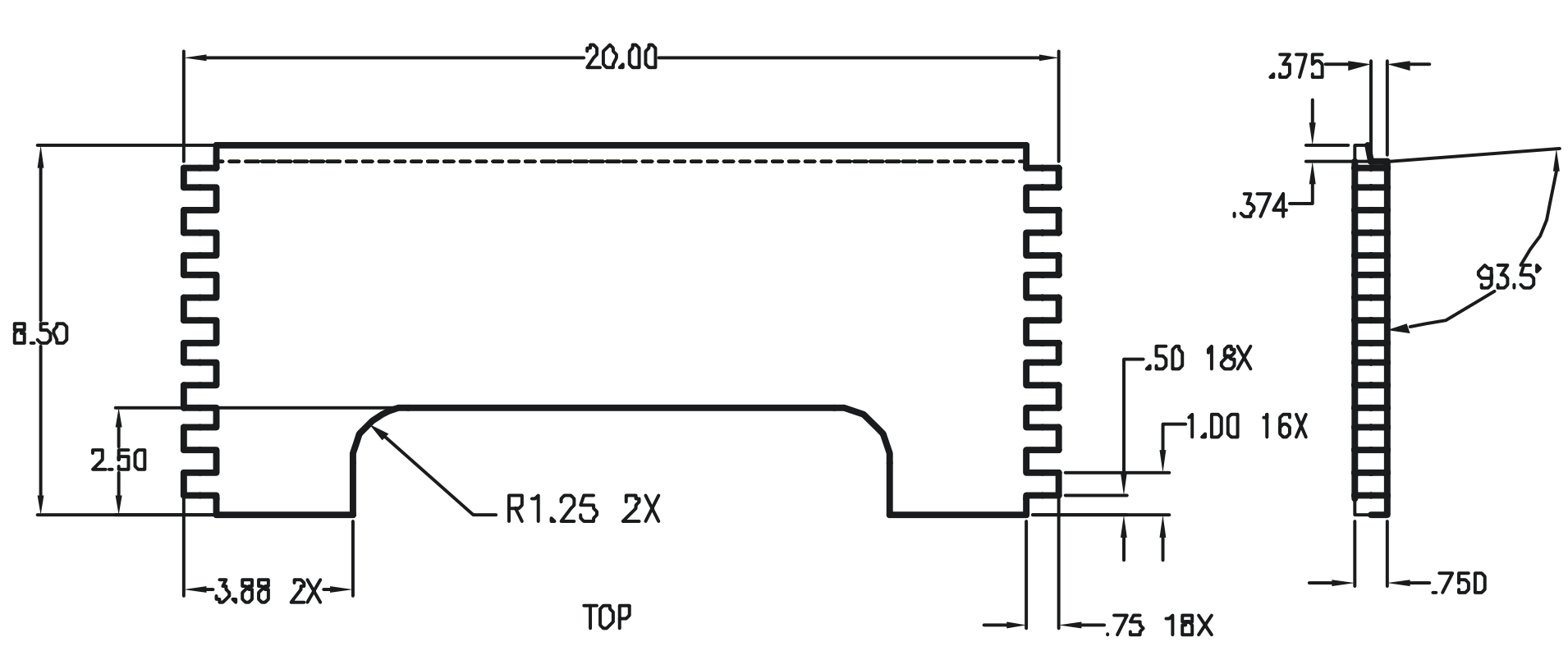

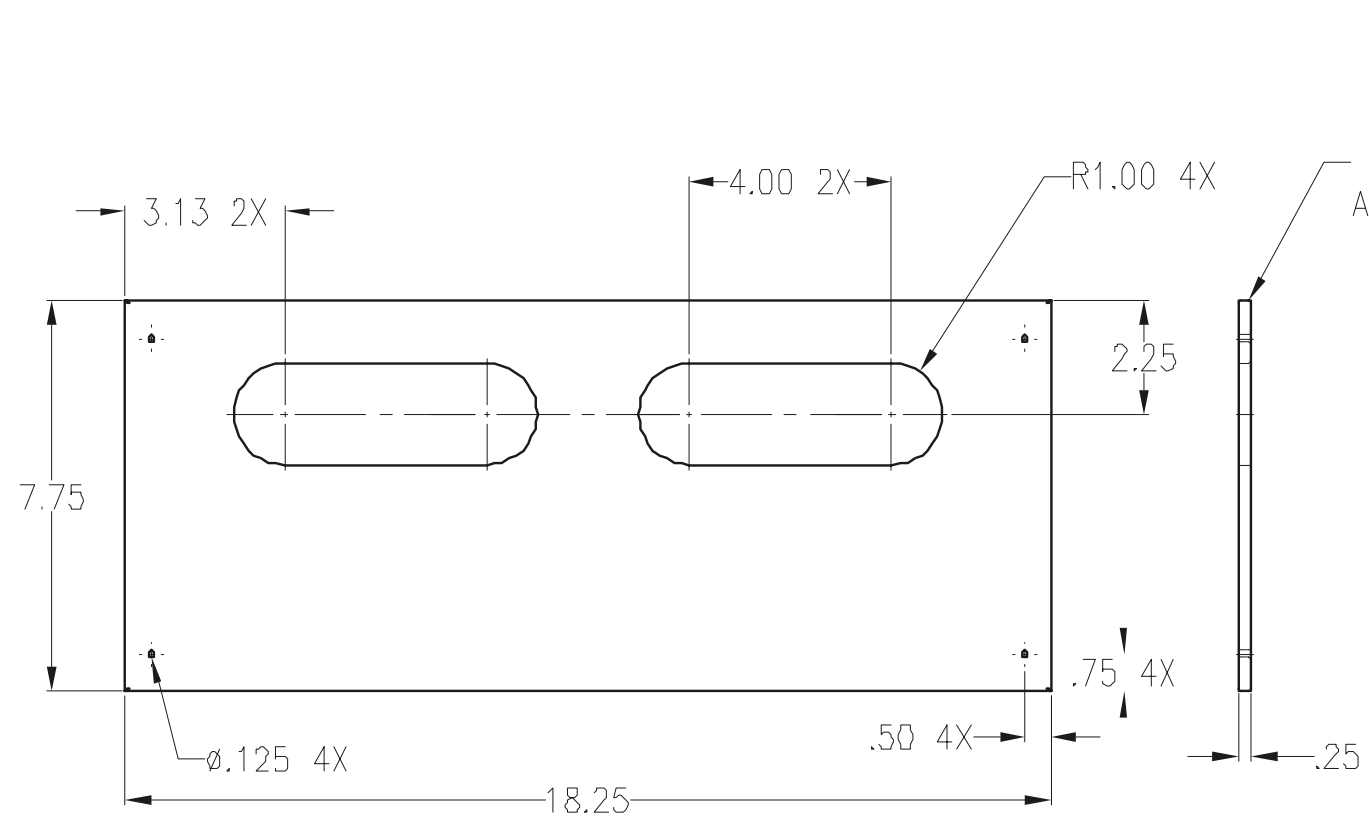

UPPER BACK PANEL

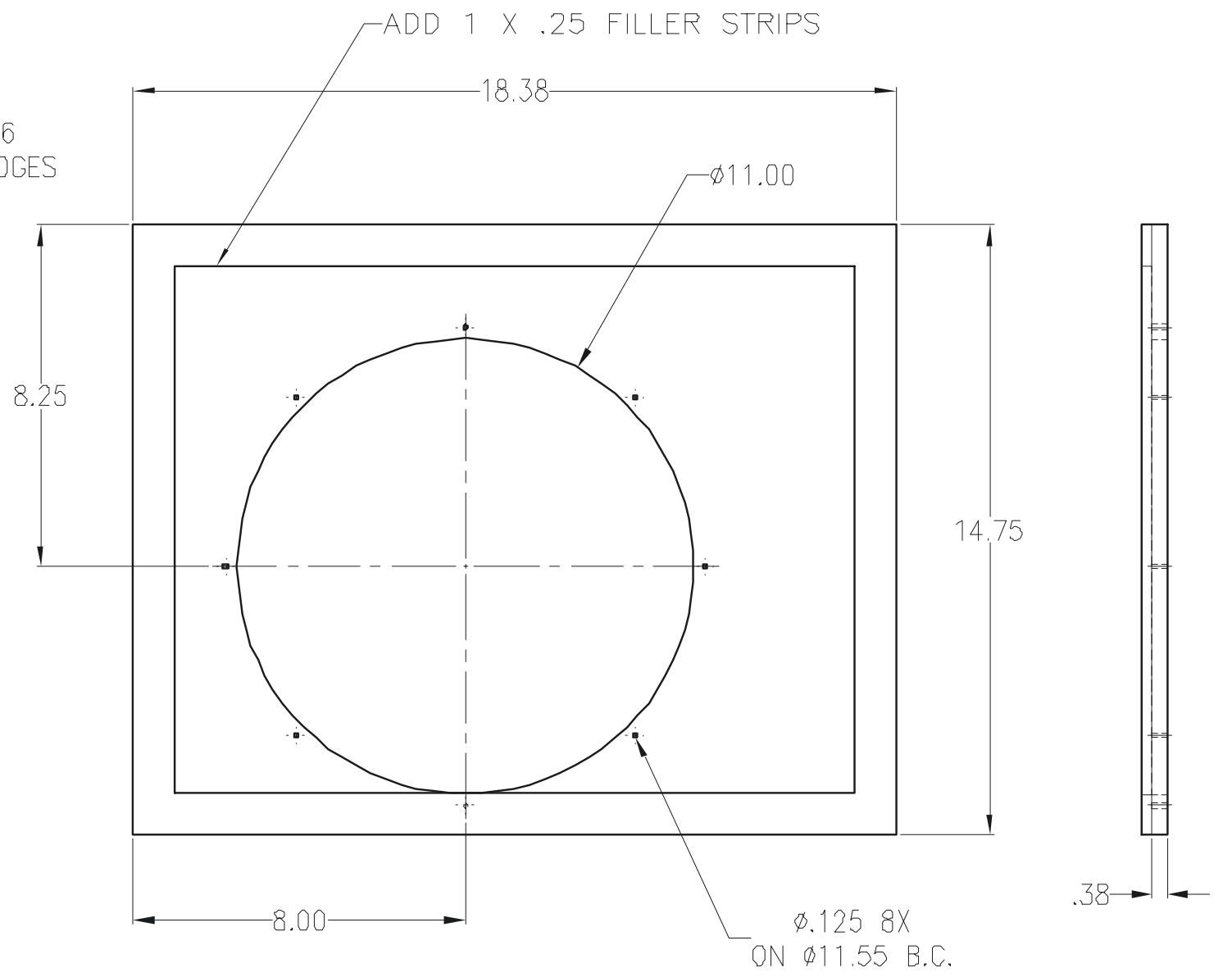

SPEAKER BAFFLE

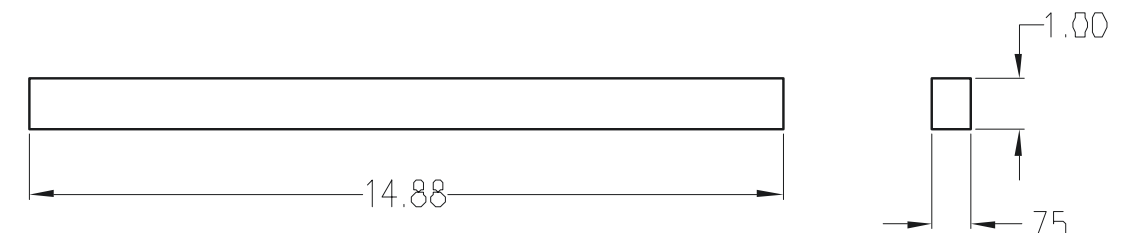

CLEAT TWO REQUIRED

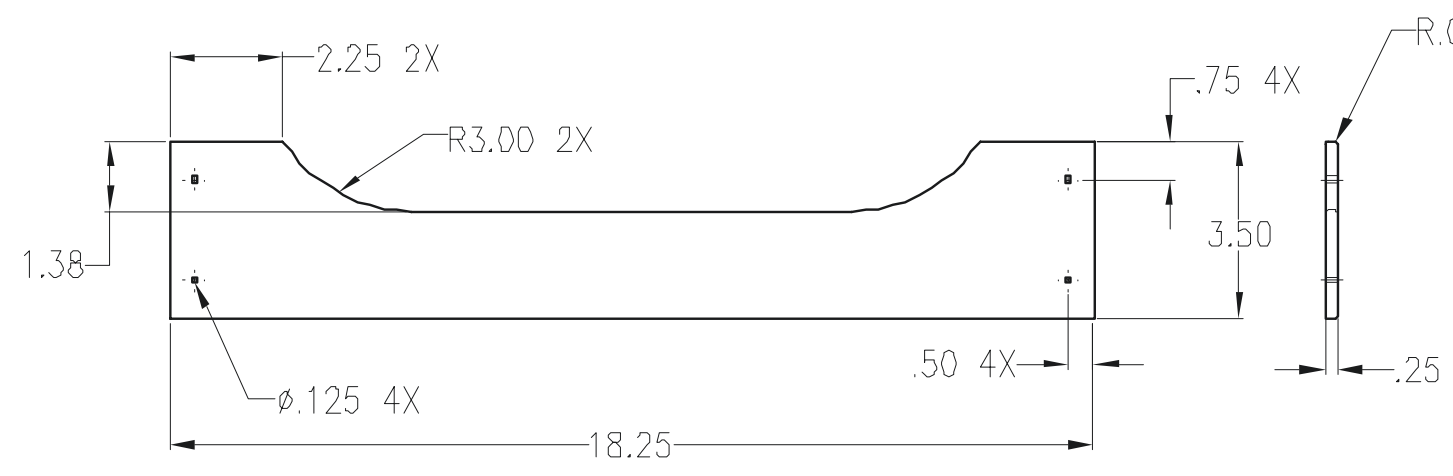

LOWER BACK PANEL

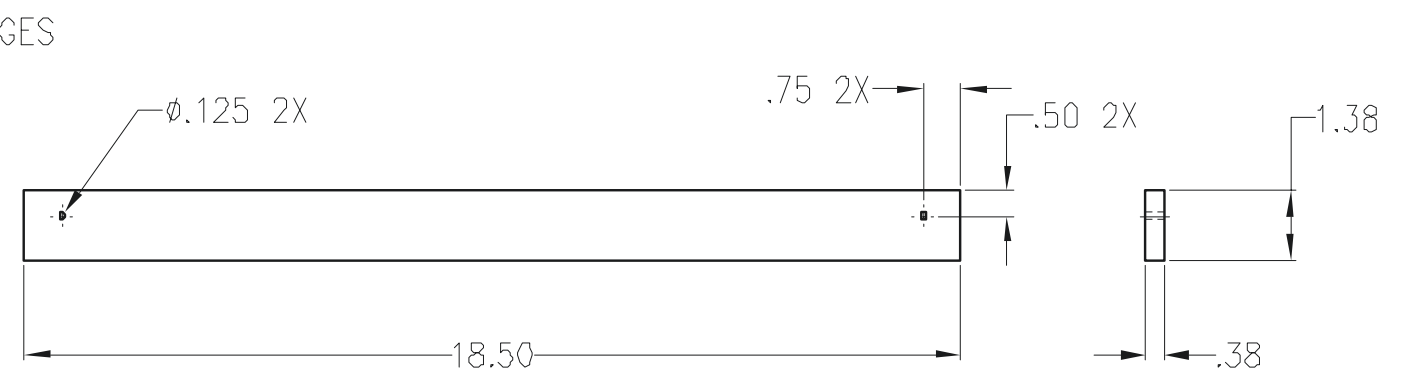

FACIA TWO REQUIRED

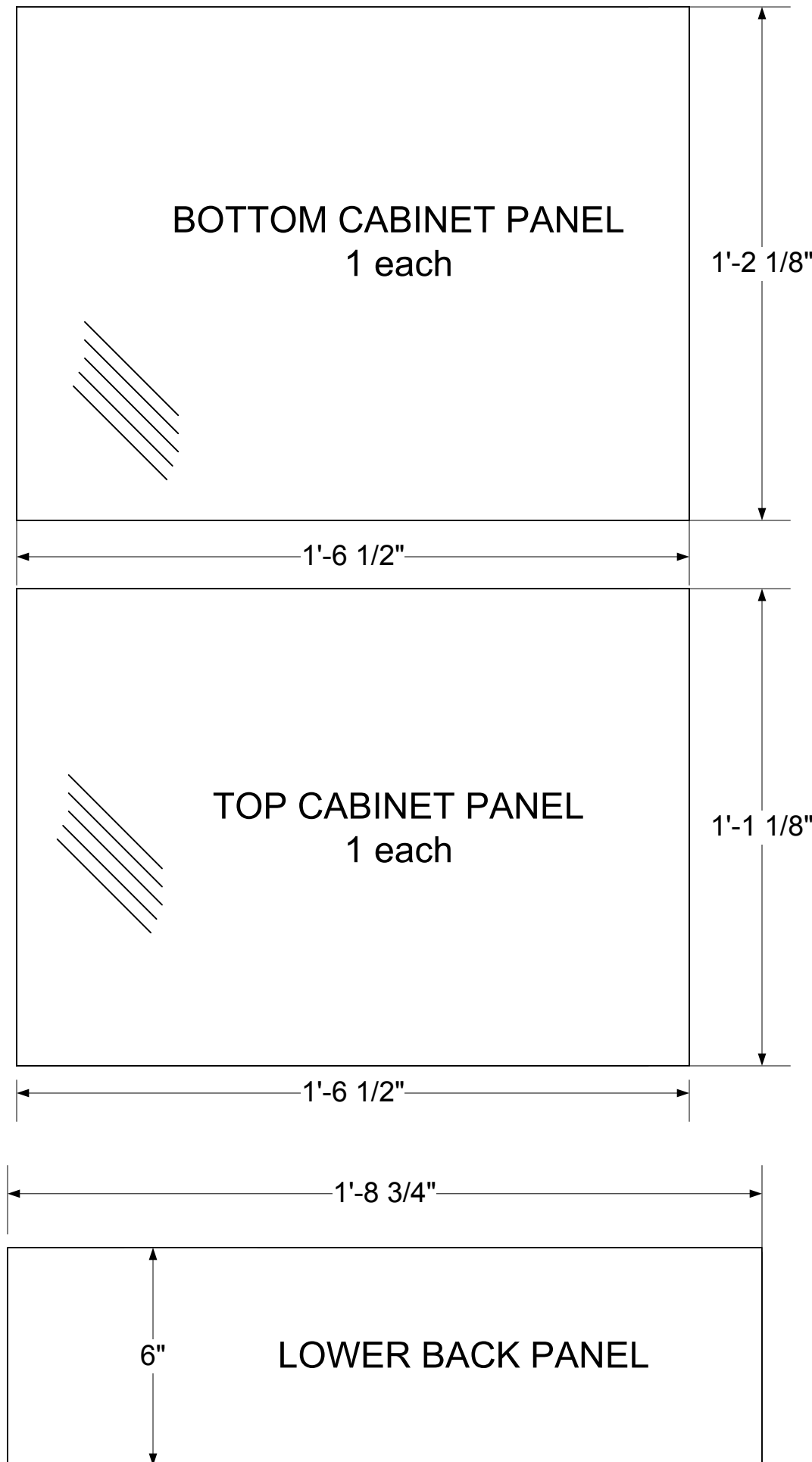
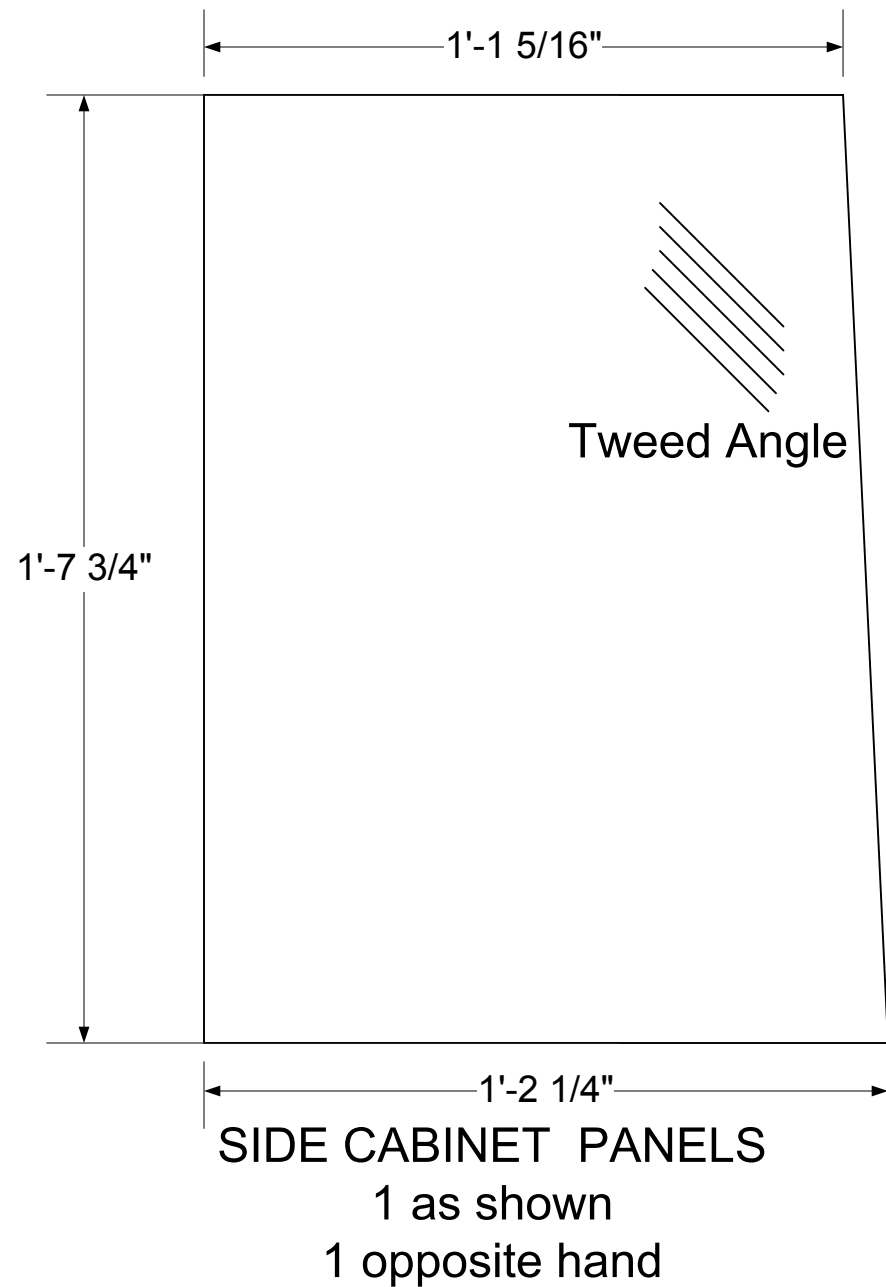

Notes:

Use a water based neoprene contact adhesive glue It has high tack, but can be repositioned, lifted and reset if necessary. Once it is correctly placed, a quick pass with a roller will remove any voids or bubbles.

Use a framing square to make sure you cut all panels with the tweed pattern running exactly at 45 degrees and that the panels are true rectangles. Use a fresh razor blade to cut the panels to minimize fraying of the tweed. When measuring for the end panels allow a 1/2" overlap with the top and bottom panels in your measurement. Draw pencil lines on the top and bottom of the amp where the end panels will stop to help with placement of the end panels. Do this after the glue is applied so you don't cover your marks. Also, mark a centerline on the top and bottom of the cabinet for reference along the perpendicular pencil lines and a corresponding mark on a small piece of blue painters' tape placed on the center of the tweed panels. Position the tweed panel's edge at the pencil line and the center reference marks when applying the panels. This will facilitate front to back and top to bottom alignment.

Smooth the side panel from the top of amp to bottom first, then pull the side panels' edge material around the front and back edges of the cabinet and cleats, making the necessary relief cuts. A disposable plastic putty knife is helpful for tucking the tweed into the crevices where it wraps around the back panel cleats.

Before moving on, lightly roll the flat surfaces to make sure the panel is properly adhered. For the corners, you pinch the material (wash your hands before doing this on each panel) tightly along the center of the corner radius. You end up with a triangular shaped 'fin' of tweed, that sticks to itself and is quite rigid sticking out along that radius center line at a 45 degree angle. Then take a sharp pair of scissors and cut tight along the line where this 'fin' meets the amp. You can get it cut close pretty easily. Don't be afraid of cutting them too short. It's almost impossible to cut them too short unless you pull so hard on the fin that it lifts the material away from the amp. The material at the corner should be stuck really well at this point and you'd have to pull hard to detach it. Once it's cut, the edges of the cut will be sticking up slightly, but a quick pass with a roller will lay the edges down and they will meet each other nicely. Start with a lower rear corner, then lower front, then the more visible upper corners just in case.

The top and bottom panels are pretty straight forward, but again use alignment marks on a small piece of the blue painters tape on each piece to make alignment easier. The overlap on the end panels isn't folded over, just laid on top of the them.

Apply glue to both the tweed and the cabinet surfaces and let dry to touch for about 30 minutes before placing each panel. On the two outside corners at the entrance to the control panel cutout, use the same 'pinch' method creating the same fin and trim close with scissors. Then roll the seam as before. After trimming, use your finger tips to press the cut edges down to each other tightly, then hit them with the roller.

Take your time and do only one panel at a time. Make sure you place the filler pieces at the inside curves of the control panel cutout first before placing the top panel. Also, do not overlap these filler pieces onto the top of the amp or you'll see it after the top panel is placed. Keep a sharp razor blade in your knife.